

# PRIMERITE™ CT012E

## 12" X 12" AUTOMATIC DRY SELF-PRIMING TRASH PUMP



### APPLICATIONS

Construction  
Dewatering

Sewage Bypass

Flood Drainage

Mining/Quarries

Municipal

General Industrial

The Primerite™ is the perfect pump for contractors, pump rental companies, mining operators and general industrial or municipal use. The pump's oil-filled bearing box and a mechanical seal in an oil bath enable it to run dry all day long for up to 24 hours, making it the right choice for handling inconsistent flows found in sewage bypass pumping and job site dewatering. This pump is completely self contained in either skid or trailer configurations with integral lifting bail, tie downs and fuel tank.

### FEATURES

- Primes and reprimed automatically
- Belt driven compressor is air cooled and oil lubricated
- Vacuum and discharge pressure gauge
- Forklift slots (skid models)
- Skid mounted
- Heavy-duty truck tie downs
- Lifting bail
- Motors - U.S., WEG or equivalent
- Volute drain
- 12" ANSI Pattern flanges – Suction and discharge
- Optional float activated, auto start/stop controls
- NEMA 3R pump control panel
- Optional VFD for variable speed

### QUICK SPECIFICATIONS

Suction connection	12" 150# ANSI B16.5
Delivery connection	12" 150# ANSI B16.5
Max capacity	6000 GPM
Max solids handling	3"
Max impeller diameter	13.8"
Max head (TDH)	90'
Max operating speed	1780 RPM
Max suction lift	24'
Dimensions	62 x 75.6 x 84"
Sound levels w/ enclosure	67 dBA at 7M / 23'



## PERFORMANCE CURVE

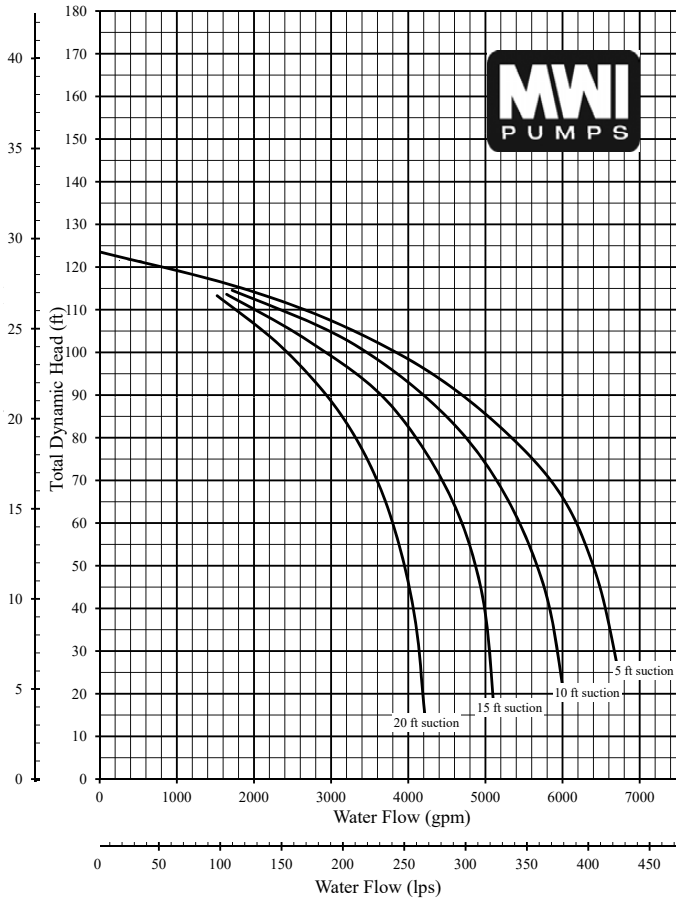

## MATERIALS & SPECIFICATIONS

Motor enclosure	TEFC
Motor HP	150 HP
Drive type	Direct drive replaceable element
Impeller	Abrasion resistant materials
Volute	Ductile cast iron ASTM A536 grade 70-50-05
Pump shaft	1045 Steel; Stainless steel option
Compressor	Oil lubricated and air cooled
Priming assembly	304 Stainless steel venturi
Discharge non-return valve	Val-matic swing flex check valve ASTM A536 grade 65-45-12
Mechanical seal	Stainless steel with silicon carbide faces; Buna elastomers
Weight	6000 lbs

## DIMENSIONS

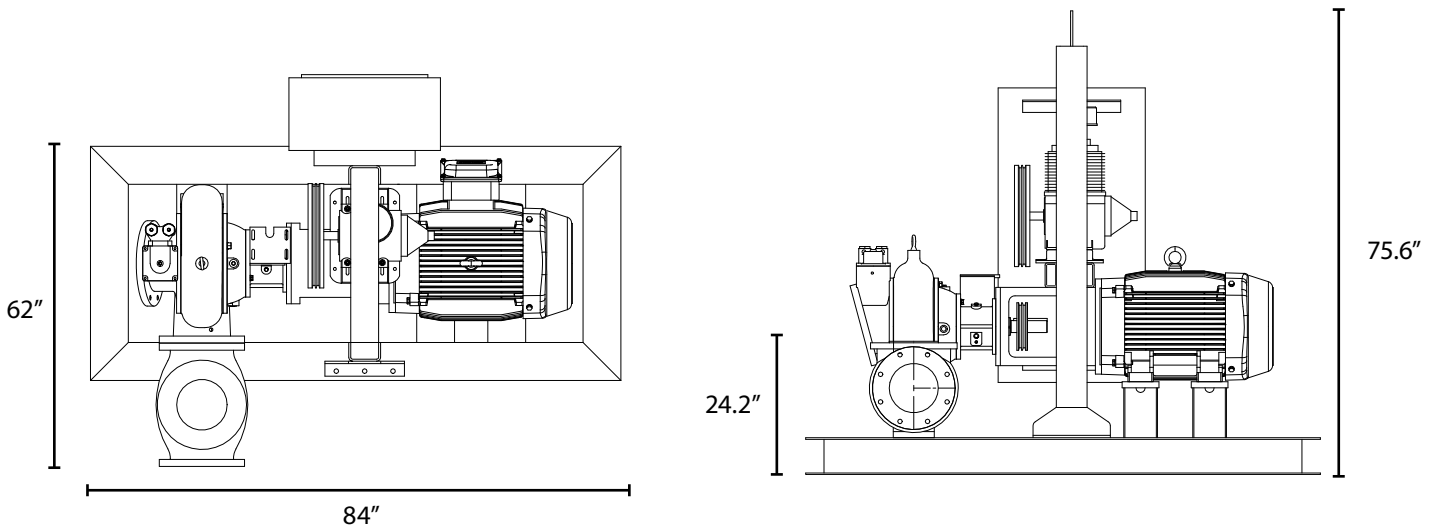

### MWI Pumps Headquarters

33 NW 2nd St | Deerfield Beach, FL 33441

Copyright © 2019 MWI Pumps | All rights reserved. Subject to change without notice.

Inquiries: 954-426-1500 | Fax: 954-426-8938 | Email: [info@mwipumps.com](mailto:info@mwipumps.com) | [mwipumps.com](http://mwipumps.com)