



## PWA-RC PROCESS PUMP

### DESIGN FEATURES AND BENEFITS

#### Recessed Centrifugal Impeller

- Designed for reduced liquid velocities
- Minimized casing and impeller wear rates
- Ideal for entrained gaseous or air entrained liquids
- Low liquid shearing

#### Non-clog Casing

- Circular casing design to reduce radial bearing loads at low flow operating conditions
- Oversized passages for fibrous or stringy liquids

#### Power Frame Superiority

- Superior high strength carbon steel vs. inferior cast iron power frame material
- Addresses environmental and safety concerns.
- Exclusive finned bearing frame for maximum heat dissipation
- Convenient dual oil level sight glasses provide flexible viewing as standard
- Internal surfaces cleaned, rust preventative applied, and enamel coated assuring internal casting cleanliness

#### Capacities

- Flows to 2700 GPM [610 m<sup>3</sup>h]
- Heads to 440 feet [130 m]
- Temperatures to 500° F [260° C]
- Pressures to 285 PSIG [19 bar]

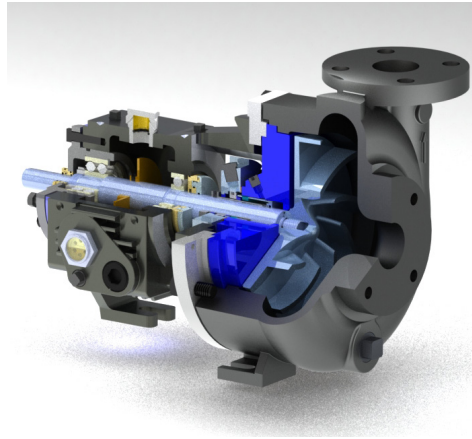

#### Quality

- Manufactured and tested in the USA

#### Casing

- Casing Steel ASTM A216 material standard for improved durability and pressure containment
- Precision serrated flange face finish for optimum gasket retention and sealing
- Class 150# standard and 300# option
- Casing thickness exceeds ASME B73.1 specification for increased casing life
- Back pull out design for easy maintenance
- Full line of corrosive resistant materials

**5 Year Unconditional Power Frame Warranty is Standard at No Additional Cost.**

Visit our website at [www.pumpworksindustrial.com](http://www.pumpworksindustrial.com) and specify flow and performance needs and obtain pump selection and performance



## HYDRAULIC PERFORMANCE COVERAGE *Performances shown are nominal and are to be used for preliminary selection only.*

### 50 HZ Performance Coverage

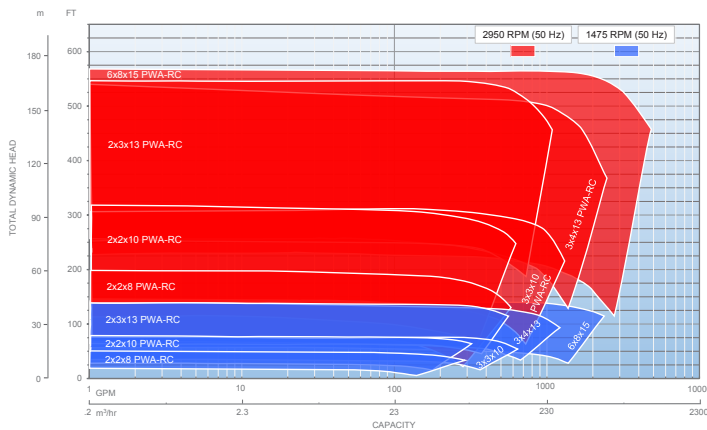

### 60 HZ Performance Coverage

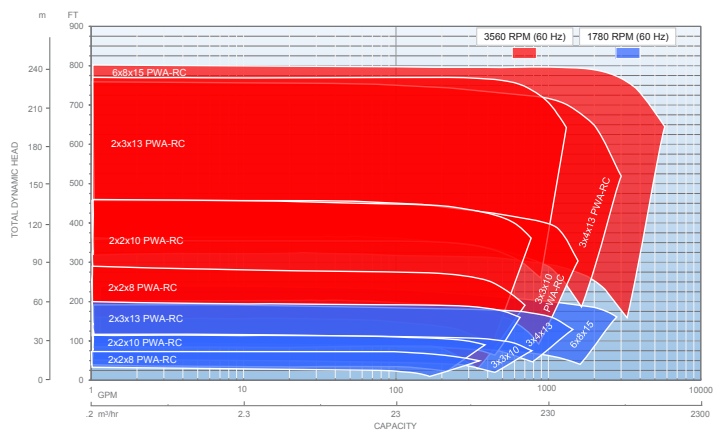

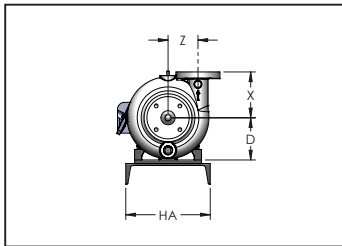
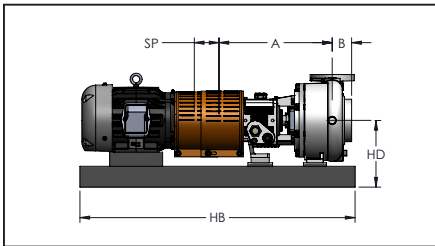
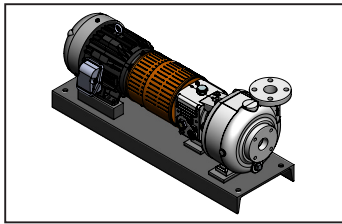
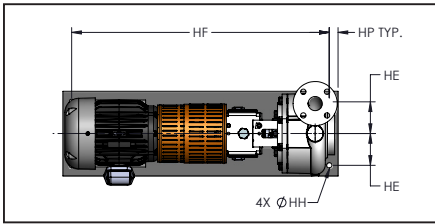

NEMA MOTOR FRAME	WEIGHT LBS AND (Kg)
182T	98 (45)
184T	128 (58)
213T	197 (89)
215T	226 (103)
254T	375 (170)
256T	412 (187)
284T	495 (225)
286T	519 (235)
324T	700 (318)
326T	756 (343)
364T	948 (430)
365T	1009 (458)
405T	1330 (603)
444T	1820 (826)
445T	1893 (859)
447T	2343 (1073)

Not to be used for construction unless otherwise certified by manufacturer.

## PUMP DIMENSIONS AND WEIGHTS

Dimensions in inches (mm), weights in lbs. (kg)

FRAME	SIZE	DISCHARGE SIZE	SUCTION SIZE	A	B	D	F	U	V	X	Z	SP	KEYWAY	WEIGHT BARE PUMP lbs AND (kg)
GROUP 1	2x2x8	2	2	15.38 (391)	2.75 (70)	6.00 (152)	7.25	0.875	1.75	6.50 (165)	4.25 (108)	3.75 (95)	.188 X .094	167 (78)
GROUP 2	2X2X10	2	2	21.75 (552)	3.50 (89)	8.25 (210)	12.5	1.125	2.63	8.50 (216)	5.25 (133)	3.75 (95)	.25 X .125	310 (144)
	3X3X10	3	3	22.50 (572)	4.25 (108)	8.25 (210)	12.5	1.125	2.63	9.00 (229)	5.13 (130)	3.75 (95)	.25 X .125	330 (153)
	2X3X13	2	3	22.38 (568)	4.12 (105)	10.00 (254)	12.5	1.125	2.63	10.50 (267)	6.63 (168)	3.75 (95)	.25 X .125	410 (190)
	3X4X13	3	4	22.81 (579)	4.12 (105)	10.00 (254)	12.5	1.125	2.63	10.50 (267)	6.63 (168)	3.75 (95)	.25 X .125	460 (214)
GROUP 3	2X2X10	2	2	21.75 (552)	3.50 (89)	8.25 (210)	12.5	1.875	2.63	10.50 (267)	5.25 (133)	3.75 (95)	.5 X .25	350 (162)
	3X3X10	3	3	22.50 (572)	4.25 (108)	8.25 (210)	12.5	1.875	2.63	10.50 (267)	5.13 (130)	3.75 (95)	.5 X .25	330 (153)
	2X3X13	2	3	22.38 (568)	4.12 (105)	10.00 (254)	12.5	1.875	2.63	10.50 (267)	6.63 (168)	3.75 (95)	.5 X .25	430 (199)
	3X4X13	3	4	22.81 (579)	4.12 (105)	10.00 (254)	12.5	1.875	2.63	10.50 (267)	6.63 (168)	3.75 (95)	.5 X .25	510 (236)
GROUP 3	4X6X13	4	6	23.13 (588)	4.75 (121)	10.00 (254)	12.5	1.875	2.63	11.50 (292)	6.63 (168)	3.75 (95)	.625 X .31	520 (244)
GROUP 4	6X8X15	6	8	32.5 (826)	5.50 (140)	14.5 (368)	12.5	2.375	4.88	14.00 (356)	7.75 (197)	5.25 (133)	.625 X .31	546 (254)

Pump approximate weights are Group 2 Power Frame. For Group 3 Power Frame, add 25 lbs. (11.5 kg). Weights and dimensions are approximate and not to be used for construction.

## BASEPLATE DIMENSIONS AND WEIGHTS

Dimensions in inches (mm), weights in lbs. (kg)

MAX NEMA FRAME	ANSI BASEPLATE NUMBER	HA	HB	HD Max				HE	HF	HH	HP TYP	WEIGHT lb (kg)
				D=5.25 (133)	D=8.25 (210)	D=10 (254)	D=14.5 (368)					
184T	139	12 (381)	39 (991)	9 (229)				4.5 (114)	36.5 (927)	0.75 (19)	1.25 (32)	124 (56)
256T	148	15 (457)	48 (1219)	10.5 (267)				6 (152)	45.5 (1156)	0.75 (19)	1.25 (32)	195 (89)
326TS	153	18 (533)	53 (1346)	12.88 (327)				7.5 (191)	50.5 (1283)	0.75 (19)	1.25 (32)	258 (117)
184T	245	12 (381)	45 (1143)		12 (305)	13.75 (349)		4.5 (114)	42.5 (1080)	0.75 (19)	1.25 (32)	133 (61)
215T	252	15 (457)	52 (1321)		12.38 (314)	14.13 (359)		6 (152)	49.5 (1257)	0.75 (19)	1.25 (32)	189 (86)
286T	258	18 (533)	58 (1473)		13 (330)	14.75 (375)		7.5 (191)	55.5 (1410)	1 (25)	1.25 (32)	278 (127)
365T	264	21 (533)	64 (1626)		13.88 (353)	14.75 (375)		7.5 (191)	61.5 (1562)	1 (25)	1.25 (32)	395 (180)
405TS	268	24 (660)	68 (1727)		14.88 (378)	14.88 (378)		9.5 (241)	65.5 (1664)	1 (25)	1.25 (32)	430 (196)
449TS	280	26 (660)	80 (2032)		15.88 (403)	15.88 (403)		9.5 (241)	77.5 (1969)	1 (25)	1.25 (32)	437 (198)
286T	368	24 (660)	68 (1727)				19.25 (489)	9.5 (241)	65.5 (1664)	1 (25)	1.25 (32)	456 (208)
405T	380	26 (660)	80 (2032)				19.25 (489)	9.5 (241)	77.5 (1969)	1 (25)	1.25 (32)	580 (263)
449T	398	26 (660)	98 (2489)				19.25 (489)	9.5 (241)	95.5 (2426)	1 (25)	1.25 (32)	839 (382)

Weights and dimensions are approximate and not to be used for construction.



PumpWorks • [www.pumpworks.com](http://www.pumpworks.com)

8885 Monroe • Houston, TX 77061 • Ph. 888-405-0209 • Fax 713-956-2141

[www.pumpworks.com](http://www.pumpworks.com) • twitter: @PumpWorks